

The Future Location of St. Benedict Parish

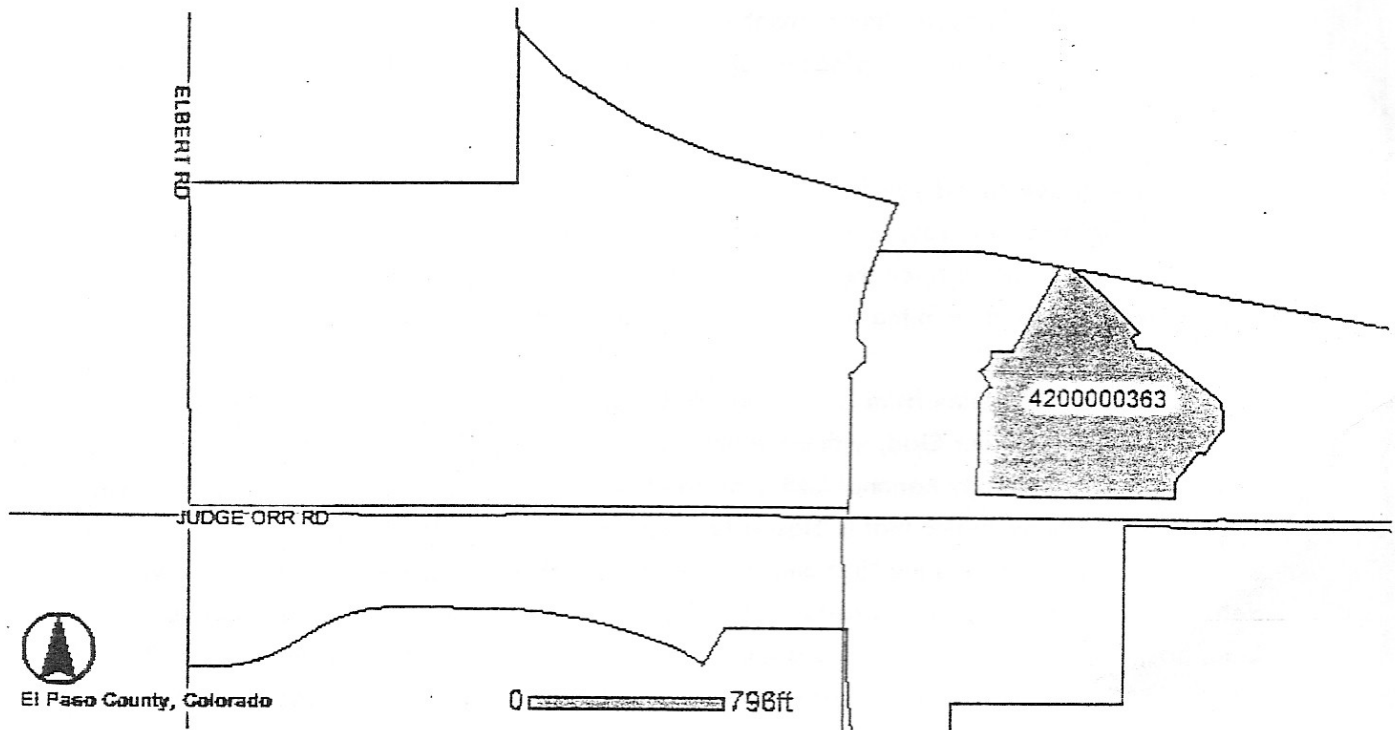

Our donated property is located a little more than $\frac{1}{2}$ miles East of Elbert Road on Judge Orr Road, or about two and a half miles East of Highway 24.

Many have asked “What happens now?” The answer is “A lot!” And, it will involve everyone in the parish, in one way or another.

The Diocese requires us to develop a Master Plan for the site and all that will be built on it. That requires detailed documentation of our needs, and selection of an architectural firm to provide us with all of the site development, construction and design details we will together make decisions about before a construction contract can be let. Fortunately, we have already done a good bit of the needs assessment for Phase I of our construction program – a multi purpose building.

The Parish Building Committee will be having an organizational, kickoff meeting in the very near future. This group will be reporting on their work via the Sunday Bulletin and the parish web site. Additionally, they will be seeking parish wide input on all facets of the project, as well as participation on the various sub committees needed to work on elements of the planning process.

We have the land, now we begin our work together.